

# The Painswick Beacon

Vol. 24 No. 9

December 2001

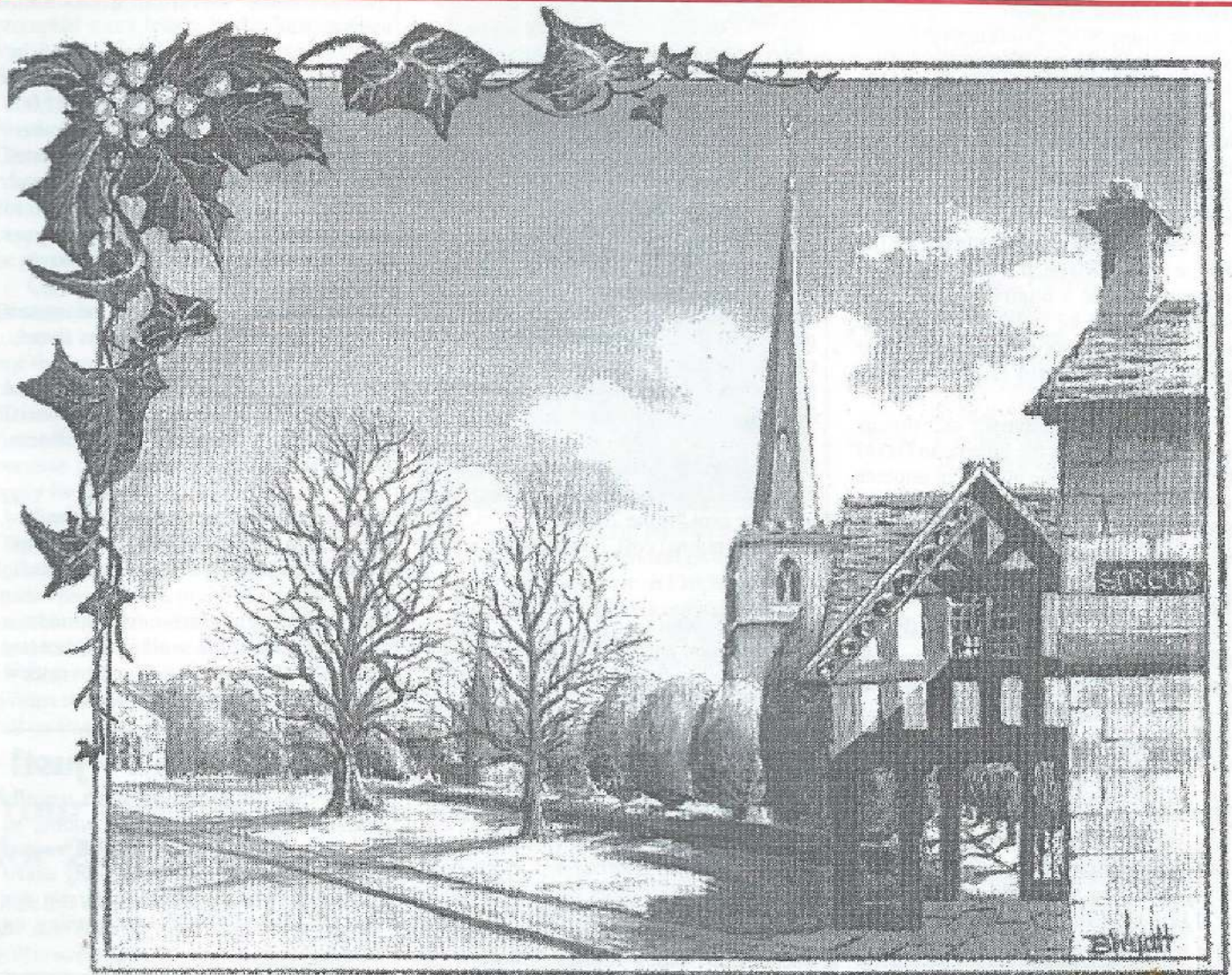

The Beacon is most grateful to Barbara Wyatt, a member of Painswick Lawn Tennis Club and the Lansdown Art Club, for this delightful front page drawing

*A happy and peaceful  
Christmas to all our  
readers and advertisers*

## Gesture of thanks for your support

Traditionally, the Beacon holds a Christmas Draw for subscribers. Our income comes almost entirely from voluntary personal subscriptions and business advertising. The draw is a token of our appreciation for your support. This year's lucky winners are:

### Subscribers

Mrs M Queenborough of Springbank Cottage in Pitchcombe (003) - bottle of whisky.

Mr WK Farlow of 5 Randalls Field (362) - bottle of sherry.

Mr & Mrs O Dixon at Viners Wood House, Wick Street (596), and

Mrs M Ireland at 3 Hillview Cottages, Gloucester Street (231) - boxes of chocolates

### Advertisers

Sara Colver-Smith of Smith Brothers - bottle of brandy

## Community carols

Everyone is most welcome to this year's community Carol Service that will be held at Christ Church, Gloucester Street, on Wednesday 12th December, at 7pm. There will be traditional carols and readings, plus contributions from local churches and schools, and items sung by Cranham Village Choir. The Vicar of Painswick, Rev. John Longuet-Higgins, will give a brief address.

Other Christmas services on Page 3.



## Meeting of 21st November, reported by Iris McCormick

### Neighbourhood Wardens

A letter from SDC Community Safety Partnership notified the Parish Council of its failure to secure funds for the Neighbourhood Wardens Scheme. David Hudson reported that the District Council intended to make a revised bid. There was some discussion as to whether to support the next bid.

Although there is good support for the scheme in the village, it was thought that as Painswick has a relatively low crime record it would be unlikely to receive much attention from the wardens. The revised scheme would cost the parish £3,250 per year.

It was agreed to leave the decision as to whether to support the scheme to David Hudson who would be attending another meeting shortly at which he would be able to judge whether it would be in the interests of the village to join.

### The Parish Plan

The Parish Plan has been made available to the Parish Council which is to consider possible amendments at a meeting on 28th November. The plan has been favourably received by the Countryside Agency which has agreed the full funding.

### Affordable housing

Stroud District Council informed the Council of Wadsworth Landmark's interest in providing self-build opportunities for affordable housing on exception sites.

District Council said that there was a shortfall of four affordable housing units in the village.

The Gyde House trustees have agreed to consider the proposal for affordable housing on the exemption site below Hoyland House, and have written to the Charity Commissioners to seek their view.

### Accident at the Lychgate

It was reported that there had been an accident in New Street at the Lychgate. Mrs D Moore was struck by the wing mirror of a passing lorry.

### Playground equipment grant

Malcolm Watts announced that the Parish Council had received a Rural Projects grant of £1,000. It was decided to use the money for playground equipment in the Recreation field. Malcolm Watts is to look into the cost of buying a roundabout.

### Budget for 2002/2003

The Parish Council announced an increase of 11 per cent for the 2002/03 budget, due to an exceptional cost. See separate report on Page 8.

### Safety at School Gates

Martin Slinger announced that parents are to drop and collect pupils at The Croft Primary School from outside the school gates, rather than inside the school grounds. This follows concern regarding an increasing problem with road safety and school pupils.

### Golden Jubilee

The Parish Council received a letter from Buckingham Palace declining the invitation for the Queen to visit Painswick during the Golden Jubilee celebrations because her itinerary had already been arranged.

### Painswick Centre

John Stephenson-Oliver told the Parish Council that there might be serious difficulties for the centre following a review of their 1906 deed. The terms of the deed require public elections for trustees.

### Format of meetings

The working party set up to look into improving Parish Council meetings reported on a number of issues. It was thought that decision items should be dealt with first, that meetings should not exceed two and a half hours, including the planning meeting, and that any significant correspondence should be circulated prior to meetings.

### Miscellaneous

Martin Slinger, snow warden, said there could be a serious problem if farmers were required to use snow ploughs this winter.

The snowploughs had not been used for 12 years due to warm and dry winter weather. However, if they were required this winter many farmers would be unable to attach the snow ploughs as the newer tractors have different attachment mechanisms.

There was a letter from Sheepscombe Village Hall requesting a grant of £1,000 in the Council's next budget. Members were advised that £500 could be allocated from the Ward's budget. This was agreed. Further consideration would be given to the request at the end of the financial year when any underspend would be known.

The removal of the trig point at the summit of the Painswick Beacon is to go ahead.

Terry Parker offered his apologies for not being able to take part in the Memorial Day service, as agreed, due to illness. David Hudson took his place.

Debby Lang has been appointed the new Area Youth Officer. The Painswick Youth Club is still looking for a new assistant.

There has been some correspondence about the dry stone wall in Gloucester road. The County Council are to review the plans for improving the bank.

## Better than TV - just!

*Parish Council meetings don't usually attract many members of the public, so councillors were amused at a recent meeting when a resident, on being asked if there was a particular reason for coming, replied "there was nothing on television."*

### DID YOU SEE...

The article in the November issue of Cotswold Life about Valerie Dugan of The Sheldan Shop in St Mary's Street? Valerie was interviewed about her work as a calligrapher and botanical artist. She has won many awards, is a member of the Cotswold Craftsmen, and has just finished another successful exhibition at the Town Hall with Ian Shearman, local landscape painter and ceramic artist.

Garages and All Building Maintenance  
Natural Stonework a Speciality  
Extensions

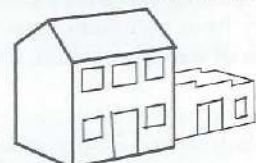

**HORNE & KILMISTER**

General Builders

For Free Estimates phone

Painswick 812760 or 01453 872329



**SMITH  
BROS.**

**GENERAL BUILDERS  
AND DECORATORS**

- NATURAL STONEMWORK
- ROOFING - ALL TYPES
- NEW BUILD & EXTENSIONS
- ALL REPAIRS - MAINTENANCE WORKS
- ESTABLISHED 1956

2 Gloucester Street, Painswick,  
Gloucestershire GL6 6QN  
Telephone: Painswick (01452) 813051



## Orange phone mast meeting

The report in last month's Beacon of the conditional approval for the Orange mobile phone mast at Skinners Mill farm has prompted more letters to the Beacon, the Parish Council and to the chief executive of Stroud District Council.

At the Parish Council meeting on 21st November, Councillor John Stephenson-Oliver said that, as Leader of the district council, he would be meeting Orange to discuss the planning approval. He asked that a copy of the Parish Council's letter to Orange be given to him for that meeting.

Cllr Stephenson-Oliver has since told the Beacon that Orange representatives were happy to look at mitigating factors in making the mast and its equipment box less obtrusive, but they did not wish to relocate 50 metres or so further up the hill to the next field (the written suggestion of one villager) because this would mean having to apply for planning permission.

The SDC chief executive, Mr David Hagg, replied at length to Mr and Mrs Eric Johnson, of Stepping Stone Lane, who had made various points in complaint. Mr Hagg said that eight households in the neighbourhood had been informed of the plan by letter.

District Councillor Barbara Tait has also written to the Beacon. Her letter appears in full on Page 6.

## Your directory for 2002

With this month's Beacon, you will receive the new Directory for 2002. We trust this will prove a valuable and useful reference pamphlet over the next 12 months.

The committee, and Leslie Brotherton in particular, go to some lengths to try to ensure that all entries are accurate and up-to-date, but if any errors are noticed, could you please let Leslie know. His address is on the back page. Thank you.

### TREE SURGERY

#### Environmentally Sensitive

Thinning - Reshaping - Felling  
Planting: Fruit Tree Pruning:  
Wildlife Advice  
Professional Service: Fully Insured:  
Vision 21 Accredited

#### Landcare Services

6 Pullens Road, Painswick

John Rhodes

812709

## Putting the clock back...



After just three weeks of refurbishing work in Whitchurch, a resplendent clock was returned to St Mary's tower on 13th November.

Not only was the clock regilded and the red woodwork repainted, but some of the wood had rotted and has been replaced. The design has also been modified to show the year of painting, and a yew tree replaces the letter G in the bottom corner.

The clock had been suspended on two braces at the bottom of the frame and held at the top by a bar going into the tower. The diocesan surveyor, Dr Edward Peters, felt it needed to be fastened more substantially this time, and so the riggers have fixed the frame to the tower with stainless steel bolts.

### Bellringers back too

Thirteen bells were rung on 2nd November before the Licensing Service of the Rev John Longuet-Higgins in St Mary's, the Painswick band being joined by friends from neighbouring towers. On 11th November, five bells were rung for Remembrance Day.

Learner ringers have been making good progress, thanks to Alan Hodges, Jacqui Pillinger and other helpers, so regular ringing on Sundays is not too far away.

## Church services

A warm welcome is extended to all at the services listed below.

### Tuesday 18th December

2.30pm Croft School Nativity Service

### Sunday 23rd December

8.30am Holy Communion BCP:  
St Mary's Church, Painswick

8.30am Mass: Church of Our Lady  
and St Therese, Painswick

9.30am Holy Communion ASB:  
St Mary's Church, Painswick

10.30am Sunday Meeting: Friends  
Meeting House, Painswick

11.00am Holy Communion:  
St John's Church,  
Sheepscombe

4.00pm Carol Service:  
Christ Church, Painswick

6.15pm Carol Service:  
St Mary's Church, Painswick

6.30pm Evening Service:  
Methodist Chapel,  
Sheepscombe

6.30pm Evening Prayer:  
St James's Church, Cranham

### Christmas Eve

3.30pm Crib Service:  
St James's Church, Cranham

5.30pm Crib Service:  
St John's Church

7.00pm Crib Service:  
St Mary's Church, Painswick

11.30pm Benefice Midnight Mass:  
St Mary's Church, Painswick

### Christmas Day

8.00am Holy Communion BCP:  
St Mary's Church, Painswick

8.30am Mass: Church of Our Lady  
and St Therese, Painswick

9.30am Holy Communion:  
St John's Church,

10.00am Morning Worship:  
Christ Church, Painswick

11.00am Meeting: Friends  
Meeting House, Painswick

11.00am Holy Communion -  
King's Birthday:  
St Mary's Church, Painswick

11.00am Holy Communion:  
St James's Church, Cranham

## THE PAINSWICK PHARMACY

NEW STREET. Tel. PAINSWICK (01452) 812263

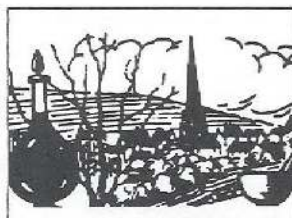

### OPENING TIMES

MONDAY TO FRIDAY

9.00 - 1.00 AND 2.00 - 6.00

SATURDAY

9.00 - 1.00





## SCHOOL NEWS

*Class 6 have been writing poems for Remembrance Day:*

The heat of battle  
The horror of battle  
My friend is gone  
And the way I'm heading  
I'll see him again.  
Without him I'm a nobody.  
Will that bullet end my misery?  
Everything is black  
Where am I?  
Is this a dream?  
I'm feeling light hearted for the first time  
in months.  
There's my friend.  
I am healed.  
Is this heaven?

**Cieran Douglass**

Rushing leaves going past, bluebells  
scattered on the floor, not here!  
Booming bombs come crashing down,  
My face is cold, my fingers are cold,  
Frostbite maybe,  
I sit in this trench cold, wet, muddy and  
sticky,  
The icy wind whizzing by.  
I thought for a minute, faltered, then ran  
to the next trench.  
That wasn't a good idea,  
I pounced in and whipped my face.  
The trench was full of sloshy, sticky mud,  
All over I stuck to the mud.  
I felt just like I was in a pond of quick  
sand,  
I heard the steamy tanks clanking past,  
I thought, then faltered,  
I ran out to battle and hoped to live.

**Lucinda Black**

Sound of gushing water and robin  
twittering, not here,  
Voices and chattering of children, not here,  
Beautiful flowers blushing in the meadow,  
not here,  
The warmth by the fire, not here,

**A.J. BULLINGHAM  
LANDSCAPE &  
GARDEN SPECIALIST**  
All aspects of garden work undertaken

- Ponds • Patios
- Brickwork
- Dry Stone Walling
- Turfing • Plating
- Fencing
- Tree Surgery

**01452 813155**  
**Mobile 0374 460139**  
3 Upper Washwell,  
Painswick, GL6 6QY



*Pictured at the school's Book Day. No prizes for knowing which book this group represents*

Lovely trees swaying in the wind, not here,  
And the smell of delicious pies, not here,  
Sounds of the church bells ringing, not  
here,  
Nothing nice is here.  
Rattling muskets and pellets, are here,  
Rumbling of tanks and troops, are here,  
Crashing guns and machine gun fire, are  
here,  
Dirty mud and sopping water, is here,  
Thunder and lightning and storms, are  
here,  
Dead and dying people, are here,  
Not very much food, is here,  
Nothing nice is here.

**Eleanor Linsell**

As soon as I arrived,  
I knew I didn't belong.  
The clammy, stinky smell,  
reached my nose.  
I heard crashing, smashing bombs,  
Trenches were thick, deep and  
Squelching with mud.  
The frost made me stiff,  
I was frozen,  
I could not move.  
My chief blew his whistle,  
It was the last thing I heard.

**Jenny Browne and Ellie Miller**

It's War.  
I'm stuck in a trench at nineteen years of  
age.  
Waiting for the end.  
I sit here frozen as the rain falls.  
It's silent.  
What am I doing here?  
I hear a thud.  
The rattling of machine guns  
Moving nearer...  
They're coming!  
We jump up grabbing our guns.  
Is this the end...?  
I'm still waiting.

**Louise Goode and Lucy Speed**

*Class 3 have been writing animal poems*  
This is the dog  
who ran to the park.  
He chased all the squirrels

Until it got dark.  
This is the fox  
Who creeped in the night  
He growled at the rabbits  
And gave them a fright.

**Clark Carrington-Windo**

This is the snake  
Who slid in the park  
And hissed in the grass  
And slid in the dark  
This is the monkey  
Who swang in the night  
And got away  
And gave the children a fright.  
This is the fish  
Who swam from whales  
and came along  
And showed its scales.

**Jacob Lee**

*And this is the first contribution from the Reception Group who have been working on the toy theme this half term:*

My best toy is a cat. It's soft and cuddly  
and brown and ginger. Daisy is her name.  
**Caitlin Workman**

My best toy is a blue rabbit. It is blue. It  
is soft and fluffy. **Chloe Needham**

My best toy is a dog. It is hard and brown.  
It is little. **Tom Davis**

My best toy is Lily. Lily is a tiny baby.  
**Laura Oakley**

**PRICE DAVIS**  
Chartered Accountants & Tax Advisers  
The Old Baptist Chapel, New Street

**We provide a local, personal service  
for every aspect of your  
taxation and accountancy needs**

Howard Davis or Glenn Collingbourne  
will be happy to deal with your enquiries

Telephone 812491  
Facsimile 812431  
Email [info@pricedavis.co.uk](mailto:info@pricedavis.co.uk)



## Painswickian of the Year Award

There has been an unprecedented response from readers to the request in last month's Beacon for nominations for the Painswickian of the Year award that the Beacon makes at the start of each year to mark exceptional efforts or achievements on behalf of others.

Committee members cannot recall ever having so many replies, and wish to thank everyone who participated.

All the nominations and testimonials will be taken into account, and the names of the chosen person or couple will be announced in the January issue.

### BOXING DAY WALK

The Parish Council's annual Boxing Day walk will start from Stamages Lane car park at 10am, returning there at approximately noon. Dogs (with their owners) are welcome but must be kept on a lead at all times. Please see noticeboards for details of the route.

### Wine and mince pies at Guild Gallery

The Guild Gallery has a bright new look for the launch on Friday, 7th December, from 7.30pm at the Painswick Centre. Come and help us celebrate.

There are new colours, lighting and displays, with plenty of ceramics, jewellery, textiles and wood, prints, cards and many small items to tempt you for Christmas. The new display has been arranged by Maggie Shaw. The gallery

will be open as usual, Tuesdays to Saturdays, from 10am to 5pm. Jan Bunyan and Mary Noble, the Guild coordinators, have been working hard to arrange this special event. Our Christmas Exhibition will be held at Cheltenham Museum and Art Gallery from 1st December to 13th January, Mon to Fri. 10am to 5pm, and Sundays noon to 4pm (Closed 23rd to 26th December).  
**Anne James**

**JOHN AND BARBARA HULME**  
**THE GROCERS OF PAINSWICK**  
Giving you personal service with local deliveries from

**THE CENTRAL STORES**  
NEW STREET  
01452 813209

Home cooked ham, roast beef,  
fine cheeses  
Good selection of wines and spirits  
**OVER 40 YEARS' TRADING**

## POLICE REPORT

### Important notice about key-holders

The recording of key-holder's details used to be operated by a bureau contractor who has given notice of withdrawal from the scheme.

The Police now maintains records of people you have nominated to hold keys for your property in order to assist all the emergency services. This enables a responsible person to be called out if an incident occurs at your property when you are not there. This service is available to everyone whether you have an alarm or not.

**Note:** Even if you were registered in the old scheme, it will be necessary to re-register with the new Police Bureau.

There are three different ways you can register your keyholders:

1. By Email on the Police web site at: [www.gloucestershire.police.uk](http://www.gloucestershire.police.uk) and follow the links to the keyholder registration form.
2. By interactive voice mail, using the Direct Dial number 01242 276776, and follow the instructions.
3. By completing the Keyholder Details form available from the Post Office or the Library, and posting it to: Gloucestershire Police, PO Box 375, Cheltenham, GL51 6YS.

Report of incidents from 14th October to 16th November

House burglaries: Pitchcombe 1.  
Business premises: Nil.  
Sheds: Painswick 1; Pitchcombe 1.  
Vehicles: Painswick 6; Slad 1.  
Other: Painswick (theft 3, damage 2);  
Sheepscombe (damage 1); Slad (theft 1).  
Total: 17.

#### Items stolen

Video, cam recorder, lawn mower, handbag and contents, wallet, CD unit, petrol, car, stone trough and trailers (2).

#### Reported incidents

Five incidents were reported, three of which were useful to the Police. Many thanks.

#### Police Information Point (PIP)

This is located in the Painswick Library. PC Breakwell will be there on the following dates:

Thursday, 6th December, 10.30 to 11.30am.  
Monday, 17th December, 10.30 to 11.30am.

**PC John Breakwell**  
and the NW Co-ordinator

### Richard R Gittins Building Contractor

Stone Masonry Work : Extensions  
Roofing & Traditional lime plastering  
Reg. NHBC and DSWA

**Tel. 01452 814475**

Beechdene, Jacks Green, Sheepscombe, GL6 7RA

## THE PAINSWICK HOTEL

KEMPS LANE, PAINSWICK  
GLOUCESTERSHIRE GL6 6YB  
TEL: (01452) 812160  
FAX: (01452) 814059

### "The Cotswolds Best Kept Secret"

A light lunch. A quiet dinner with friends.  
A family party. Prepared by our Award  
Winning Team of Chefs

#### Superb Luncheon

Served Daily 12.30 - 2.00pm  
2 courses £13.00, 3 Courses £16.00  
Traditional 4 Course Sunday Luncheon  
£17.50

#### Dinner Menu

2 courses £24.00, 3 Courses £27.50  
The best of Cotswold meat, game, Severn  
salmon and Vale of Evesham vegetables

Or simply relax by a roaring log fire and enjoy  
the peace and beauty of the Hotel with our  
**Delicious Afternoon Tea Menu**

### Michael Davis

Building and Maintenance Contractor

Painswick 01452 812598

Mobile 07889 092279

e-mail: [Mike@painswick4.fsnet.co.uk](mailto:Mike@painswick4.fsnet.co.uk)

ALL types of building work carried out.  
Natural Stonework and Dry Stone  
Walling a speciality

*Lived and worked locally for  
over 30 years*

Member of the Guild of Master Craftsmen



# What happened to zero tolerance?

I was pleased to read that the subject of village wardens was being discussed at last month's Parish Council meeting. This scheme is a certain way forward to negate the effects of the lack of police presence in the village.

However, I was disappointed to see the issue being put on the back burner as one councillor felt that, apart from the fact that wardens could not issue parking tickets, the levels of vandalism and anti-social behaviour in Painswick are not high enough.

Surely any level of vandalism and anti-social behaviour is unacceptable, and we should not be implying by our indifference

## LETTERS

that it is? The cases I have personally been aware of in recent weeks are children stealing petrol and lighting fires, and stones being thrown at the windscreens of cars driving down the B4073.

These instances are far too serious to be dismissed because they may not happen regularly; they are life threatening not only for the perpetrators, but for innocent people caught up in these mindless acts.

There is also a growing trend of abusiveness from certain younger members of the community. This can

intimidate residents not to go out at night; this is surely something we cannot condone.

So, please, members of the Parish Council give this matter some more thought. Let us help our hard-pressed police force by basically extending the theme of Neighbourhood Watch. Who knows, having wardens on the street, who are helpful and friendly, may well break down the barriers of different age groups, that can often lead to problems? Bury your heads in the sand and you could be the next innocent victim.

Paul Moir

Painswick Rococo Garden Trust

## Orange mast: Barbara Tait comments

Referring to the article about the Orange mobile phone mast in your November issue:

1. I offered to attend the Parish Council planning meeting. I was not asked to attend.

2. You state that the mast at Skinners Mill farm is, according to SDC planners, in "The least intrusive location possible". What the schedule actually said, was, "...is the least visually intrusive place within the search area."

It went on to say that "the proposal would remove the requirement to erect a mast (at Hoyland House) within the Conservation Area" I made this point several times at the Parish Council planning meeting and even presented them with a Conservation leaflet. You fail to mention this important point.

The statement made by Terry Parker about Orange deciding not to erect a mast at Hoyland House, was quite irrelevant.

The planning permission at Hoyland House still stood. The decision taken by SDC was to "Resolve not to refuse ...subject to...this proposal being a substitution for the mast at Hoyland House." The red-herring about the Severn Trent site had no bearing on this issue, as the application had been withdrawn and therefore was never considered by the planning authority anyway!

The proposed mast at Skinners Mill Farm is a telegraph pole style mast and according to our officers will not be so obtrusive at this site, because there are already several telegraph poles within that area. It is not a full telecom mast.

To draw comparisons with this mast and the ones refused by the Development Control Committee is quite alarmingly ill-informed.

The ones which have been refused by SDC are TETRA masts of which some have been reported as being a health hazard. (However, there are now new Government guidelines which I believe will make it very difficult for us to refuse these in the future).

What I stated at the Parish Council meeting was not that "only one objector had written in" but that according to our schedule, apart from one individual member of the Parish Council, only one other member had written in. (The Parish Council had objected separately, of course). However, it was reported to the committee verbally that a total of four people had written in.

The Development Control Committee (otherwise better known as the Planning Committee), are fully briefed on all planning applications.

We take note of our Draft Local Plan guidelines, and we have to take on board the professional advice of our Officers. (This does not mean that we have to follow all advice, although generally we do). As

you correctly stated, the Parish Council are invited to give their opinions only on planning applications.

I look at EVERY plan for my area, which includes Painswick Parish as well as Cranham, and Miserden. I read, note, and file all comments from the Parish Council.

It is worth pointing out that SDC can suffer severe financial penalties if an appeal is lost. It is therefore essential to get things as near correct as is humanly possible.

I would really appreciate being contacted to verify facts made in The Beacon, as I have been in the past. It really isn't good enough to alarm your readers in this manner and put extra pressure on our hard-working planning officers, who were inundated with calls following your article. I also believe that I should receive an apology from you.

Barbara Tait, District Councillor  
17 Churchill Way

### LANDSCAPE GARDENING

*A Complete Garden Service*

*Regular Garden Maintenance  
Grass Cutting, Hedge Trimming*

Construction of:-

*Ponds and Water Gardens  
Drystone Walling, Paving  
Fencing, Turfing, Seeding  
All Aspects of Tree Surgery*

FULLY INSURED

Ask for Adrian Harris

**Floribunda**

01452 527647



### RESTHAVEN

Resthaven, Pitchcombe, Nr Stroud,  
Gloucestershire GL6 6LS.  
Telephone: Painswick (01452) 812682

RESIDENTIAL/NURSING HOME  
SHORT & LONG TERM &  
RESPIRE CARE

SINGLE ROOMS  
PRIVATE CHAPEL  
BEAUTIFUL SETTING OVERLOOKING  
THE PAINSWICK VALLEY

Resthaven Home of Healing Ltd  
Regd. Charity No. 235354



# Seasonal teasers, with a prize for each one

It has become a tradition in the December issue to publish a puzzle for readers to tackle over the Christmas period. This year we have two because Eric Johnson, of Cross Hands, Stepping Stone Lane, a games designer, generously offered two of his games as prizes for this event. They are: Rapidough and BOKU. Both are suitable for family fun, and Eric has agreed to present the games personally to the winners. So, get your thinking caps on and off you go.

The basic rules are:

Beacon committee members and their families do not qualify.

Only one entry per household, please.

Entries, giving a full name and address, should be sent to Leslie Brotherton, Longhope, Blakewell Mead, Painswick

## HOW WELL DO YOU KNOW GLOUCESTERSHIRE?

Find the 20 places in the county concealed in the phrases below: The first all-correct list will win BOKU.

1. Sounds rather rough
2. Could be freezing
3. Harry Potter bird sanctuary
4. Well distributed weight
5. Successful pugilist
6. Military Academy
7. Murder committed at a higher level
8. No pollution here

9. On the road to Damascus
10. Dropped the letter?
11. Diminutive cleric
12. Solidified tree
13. A weight of nuts
14. Freshwater inhabitant
15. Birds passing place
16. Creamy beer's origin
17. Lot's wife's destiny
18. 100 to 1 outsider
19. Guitarist's home
20. A source of energy

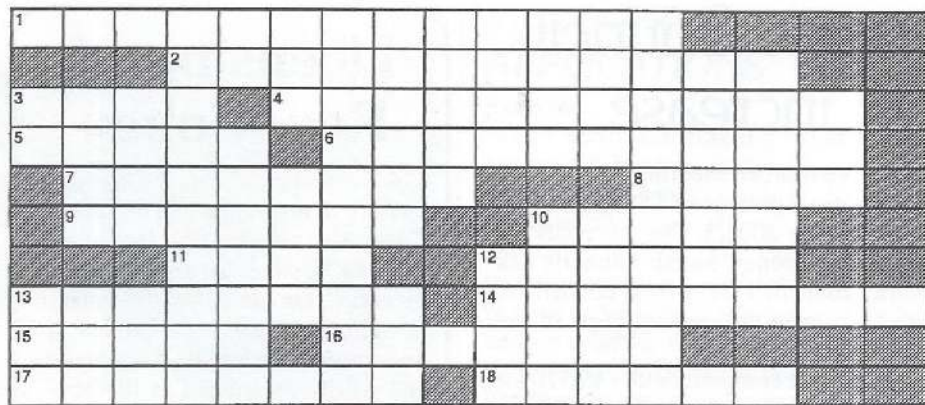

GL6 6UR to be received no later than 3rd January, 2002.

In each quiz, please list answers in the correct numbered sequence.

The committee's decision is final.

### Crossword

Local knowledge will be helpful in answering the clues. All Across. Five words associated with Christmas time are hidden Down.

The first correct crossword, or complete list of 18 answers, plus the five hidden words, will win Rapidough.

### Clues

1. Heavy feet at the Centre (5,8)
2. Super-clean lesser thoroughfare (8,4)
3. Manorial gust (4)
4. Bright lozenge, recently re-coloured (6,5)
5. Game worth a try (5)
6. En route to bath (6,4)
7. Opposite a mouse, with a scent (8)
8. The (leafy suburb of Painswick) (4)
9. Sound from the youths in the tower (7)
10. Eighteen at 300m, nineteen including a drink (5)
11. Cold tyres welcome it from bins (4)
12. Keep your feet still near St Mary's (6)
13. Well-known local name, thoroughfare, leads to the 16 (4,4)
14. Super field, hereabouts, for 5 (8)
15. Tombs for a feast, but no room for chairs (5)
16. Recently added a Welsh name to its team, post Roddy (7)
17. Hills we should know well (8)
18. Journal close to your nose (6)

## Cotswold Care Hospice news

Our 'new look' Autumn Fair in October was a great success, with two new ventures for us this year. First was a very colourful flower stall that was completely sold out by closing time, and then at midday the hall was filled with the delicious smell of very tasty hot lunches.

These, together with our usual popular

cakes, gifts and bric-a-brac stalls, the raffle and a further stall at the united charities bazaar the following week, made a very successful effort. This was topped by a generous donation, making a total of £1006.69 for the work at the hospice. Thank you to all supporters.

Flora Semark

### BAY TREE GARDEN SERVICES



Landscaping  
Fencing  
Lawn and Hedge Work  
General Maintenance  
Water Features  
Garden Design  
Free Estimates

Tel: 01452 538264  
Mobile: 07900 684899

www.baytreegardenservices.co.uk

### COTTAGE CLINIC, PAINSWICK PHYSIOTHERAPY AND SPORTS INJURIES

We treat pain...

neck  
shoulders



and everything  
in-between!

back

knees

feet

Also post-operative  
rehabilitation

Please telephone for an appointment

01452 812344

## LAWNMOWERS SERVICE • REPAIR • SALES

- HONDA
- MOUNTFIELD
- QUALCAST
- STIHL
- HAYTER
- ATCO
- FLYMO
- WESTWOOD
- KUBOTA
- COUNTAX

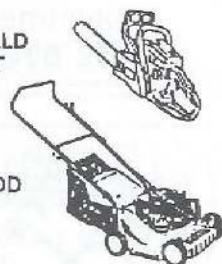

FREE LOCAL  
COLLECTION & DELIVERY

CHELTENHAM MOWER SERVICES  
MOBILE: 0831 282533  
TEL: 01452 714098

www.users.globalnet.co.uk/~cmowers



## Parish Council tax increase

At its November meeting, the Parish Council set a precept of £50,530 for the financial year 2002/3. The precept is the amount of money parish councils ask district councils to levy from council tax payers to meet the running costs of the parish.

The figure compares with £45,520 for the current financial year. In percentage terms this is an increase of 11%.

The Parish Council, however, is concerned to emphasise to residents that the percentage increase would have been only 3.2% had Stroud District Council not taken the decision to cease funding the St Mary's Street toilets. The District Council's precept increase guideline to parish councils was 4%, but Painswick's parish councillors were unanimous in their wish to retain the toilets, believing that most parishioners would support their view even though the annual cost is more than £3,000.

## Now we are six

Although expected, the news that the Privy Council has approved the expansion of the Painswick Benefice has been generally well received with our Vicar, John Longuet-Higgins, reminding us that the most exciting initiatives take place across parochial parish boundaries.

The Order in Council was made on 31st October, and means that the Benefice now comprises the parishes of Cranham, Edge, Harescombe & Brookthorpe, Painswick, Pitchcombe and Sheepscombe.

### CHIROPODY

at  
Painswick Surgery  
Gyde Road

Appointments  
01452 812545

CLOCK & WATCH REPAIRS



J. D. HOBBS  
B.A. Hon. H.N.D., Grad. B.H.I.

01452 812762

A Graduate Of The British Horological Institute



## Licensing of Rev. Gobey

On Wednesday 9th January a Service of Institution will be held in Gloucester when the Rev. Ian Gobey will be licensed to the enlarged Benefice. On Sunday 13th January at 3pm, there will be a Service of Induction at St John's, Edge when Ian will be welcomed as the non-stipendiary minister for the enlarged Benefice. Archdeacon Geoffrey Sidaway will lead a Service of Commissioning and Commitment.

## Legion's thanks

On behalf of the Royal British Legion, I would like to thank all those helpers who sold poppies this year. We had some new collectors - The Croft School had their own collection and we warmly welcome you. Well done.

Our total came to £2,019.62, slightly up on last year. This was made up as follows: House-to-house, £1,088.14; Street collection, £106.82; Static points, £493.12; Church Service, £298.79; Wreaths, £32.75.

I also wish to thank Mr. and Mrs Denys Hill who let us use their house on the Friday and Saturday of Remembrance Weekend and supplied refreshments.

Mary Muller

## Busy times at tourist office

The Tourist Information office is now closed for the winter and will re-open next Easter.

After a very slow beginning to the season because of foot and mouth, we closed on a high note, with so many visitors one October afternoon that the volunteer on duty lost count of how many visitors and questions he had answered.

On the final day, 3rd November, we had had 4,202 visitors, with 2,630 of those in the last three months. When comparing with last year we did in fact have more visitors in 2001. Volunteers are now going to take a rest, that is after taking tea with Mr and Mrs French at Chancellors on 3rd December.

We shall need more volunteers for Summer 2002, so if anyone can give three hours of his or her time and enjoys meeting people, please call me on 813506 for further information.

Terry Causon

## Cancer Research Fayre

Cancer Research Campaign are holding their Christmas Fayre and coffee morning on 15th December in the Painswick Centre, from 10am to 1pm. Please come and give your support on the day.

Our bazaar at Archway School in November raised £1,986. Thank you for the donations and gifts for the White Elephant stall which made a profit of £136.80.

Nora Regan

## Playgroup ready for festivities

With the festive season fast approaching, Painswick Playgroup are busy preparing their Christmas activities. The children have been learning some carols, making cards and decorations for the tree - the playgroup building is looking very festive.

Rehearsals and preparations are going well for their Christmas Nativity, and Father Christmas has agreed to visit the children at their Christmas Party. He will be distributing presents, and I'm sure great fun will be had by all.

Fundraising has gone well this year.

Our latest venture, the Stroud half marathon, raised over £200. Thank you to Linsey Grant and Claire Hurst for taking part. Thanks also to Mike Adlam for his help with registration, and of course to all our sponsors.

We wish everyone a very happy Christmas and best wishes for the New Year. We still have a few playgroup places available. If you would like further information please contact Beaty Bell, Playleader, on 610997.

## B&B details needed

During the 2001 season, the Painswick tourist desk at the Library has often experienced difficulties in arranging B&B for visitors.

Too often there has been no information from most B&Bs on room availability, and when telephoned no one can provide room booking information.

You can help them to help you next summer, say the tourist office volunteers, by telephoning the office on 813552 to let them know your availability, and by trying to have someone manning your telephone, especially at weekends

## Paul A. Morris

City & Guilds

General Builder \* Plastering \* Patios  
Dry Stone Walling  
Natural Stone Work A Speciality  
Hard Landscaping

19 Wickridge Close, Uplands,  
Stroud, Glos GL5 1ST  
Telephone (01453) 752004  
Mobile 0781 8087375

Email: paulmorris72@hotmail.com

FREE ESTIMATES



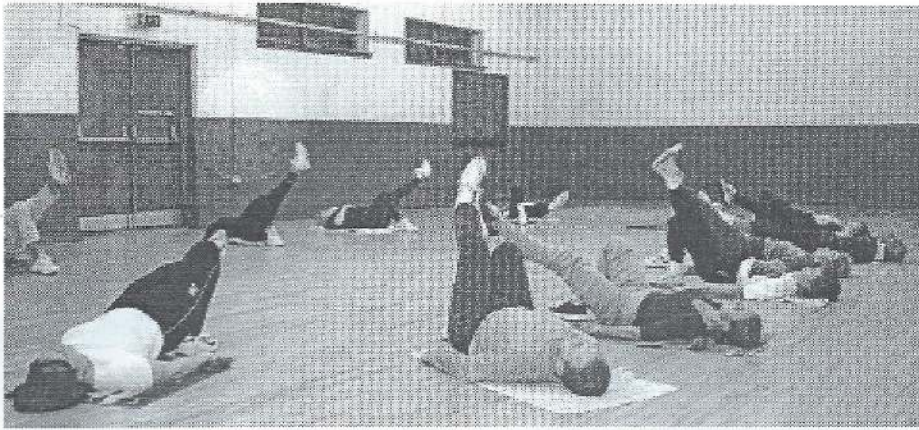

## You know what they say - no pain, no gain!

This ski-ing business can be hard work, or so it seems when you are getting down to getting fit for the piste. This group of enthusiasts (?) were working out with Libby Graesser this week at Painswick Rugby Club, the third night of their six-week course to build stamina and strengthen muscles. If you are interested, you can get more information from Libby at 01453 755948. Or turn up on Monday evenings at 6.30pm for your bit of pain and grunt - to music.

## Timely hymn from Vancouver

Jean Newell, writing in the November issue of the Parish Magazine, describes the visit she and David made to Canada in September. Jean reports that she and David flew out on 10th September and followed the tragic events of the next day on television.

On Sunday 23rd September they attended morning service at Christ Church Cathedral, Vancouver. Jean writes that "the following hymn was written the week of 11th September and gives us all courage on both sides of the Atlantic to face the future."

Jean and David believe the writer,

Carl P. Daw Jr, to be a member of the cathedral's congregation.

When sudden terror tears apart  
the world we thought was ours,  
we find how fragile strength can be,  
how limited our powers.

As tower and fortress fall, we watch  
with disbelieving stare  
and numbly hear the anguished cries  
that pierce the ash-filled air.

Yet most of all we are aware  
of emptiness and void:  
of lives cut short, of structures razed,  
of confidence destroyed.

From this abyss of doubt and fear  
we grope for words to pray,  
and hear our stammering tongues  
embrace  
a timeless Kyrie.

Have mercy, Lord, give strength and  
peace  
and make our courage great,  
restrain our urge to seek revenge,  
to turn our hurt to hate.

Help us to know your steadfast love,  
your presence near as breath;  
rekindle in our hearts the hope  
of life that conquers death.

## Singers' concert in Christ Church

Thank you to everyone that supported the recent Painswick Singers' concert, Music for an Autumn Evening. We look forward to seeing you all at our customary Christmas Concert at Christ Church next Saturday, 8th December, at 7.30pm.

Our Easter programme will present The Crucifixion in St Mary's Church on Good Friday at 7.30pm. Anyone who would like to join us for this occasion will be welcome, and practices start in the Church Rooms on Monday, 14th January at 7.45pm. Further information from Valerie or Arthur on 812400.

## PLANNING APPLICATIONS

### Received

\*Land at Lower Hazling, Slad Road, Stroud. Cladding to existing agricultural building and construction of verandah (retrospective application).

\*Stroud Slad Farm, The Vatch, Slad. To renew permission to enable the Stables to be used as temporary office accommodation for a further two years.

\*Woodside, Jacks Green, Sheepscombe. Erection of two-storey extension.

\*Wheelwright's Cottage, Jacks Green. Erection of conservatory.

### Consents

\*Mermagen House, Vicarage Street. Erection and alterations to one dwelling.

\*Packhurst Farm, Edge. Modification to design (Conversion of barn to dwelling).

\*Stamages Lane car park. Erection of free-standing noticeboard.

\*Theydon Cottage, Queens Mead. Erection of conservatory.

\*Land adjacent to Longridge Court, Bulls Cross. Change of use to Holiday Let accommodation.

\*Windrush, Jacks Green, Sheepscombe. Erection of conservatory.

\*Church House, St Mary's Street. Proposed works to garden shed.

\*10 Pullens Road. Change of use from Police Station to private house.

\*Yew Tree House, Edge. Creation of a pond.

\*Hawthorns, Longridge, Sheepscombe. Demolition of existing conservatory, and construction of replacement.

### Appeal

Planning permission granted.

\*Washwell Farm, Cheltenham Road. Erection of two-storey building to provide garage for main house and holiday let accommodation above.

## MICHAEL NYE

### Fine Woodworking

Beautiful furniture, kitchens,  
cupboards, doors, windows, boats  
==YOUR IDEAS BECOME REALITY==

Tel. Edge 01452 814372

## PAUL COOKE

### COMPLETE GARDEN MAINTENANCE

MOWING HEDGE CUTTING  
PATIOS PONDS



Free estimates  
Phone 01452 813738  
Mobile 07702 912392

VACUUM CHIMNEY SWEEP  
Phone 01452 813738

### PAINSWICK PAPERS

Have your  
newspapers  
magazines  
and comics  
delivered to your door



TEL. 814265

### G J HOGG PAINTER AND DECORATOR

Interior and Exterior Painting  
Wallpapering, Glazed Tiling

Estimates Free

8 Upper Washwell  
Painswick  
Glos. GL6 6QY

Telephone  
PAINSWICK 812505



# Painswick on song in November

Painswick First XV produced a string of successes during November in both the national Tetley Bitter Vase Competition and Division One of the Gloucestershire League.

The month began with a third round Vase match against Southmead at Bristol. Here, Painswick found themselves behind by a penalty goal to nil at half-time, only to turn the match on its head with a second half performance in which they ran in six tries. The try scorers were, Alastair Bressington (3), Martin Hayward, John Sangiovani and Chris Hall. Alastair was successful with four conversion attempts.

The following Saturday, Painswick were again away at Bristol where they met the Bristol Grammar School Old Boys side in a league encounter. Bristol seems to be a happy city for Painswick, as they were again ahead at the final whistle by 34 points to 25.

This game was a reversal of the Southmead match, in that Painswick scored all their points in the first half, with the Old Bristolians increasing their total from 10 points to 25 during the second period. Alastair Bressington scored two tries with Simon Stewart, Alex Richardson and Russell Sturmey each

crossing the line once. Alastair also kicked a penalty goal and three conversions.

Although coach Wayne Lee had told the Beacon earlier in the season that the Cherry and Whites feared no side in the league, the players were aware that their match against the league leaders, Aretians, was key to their title ambitions.

Prior to the game at Broadham, Aretians held the top spot in the division and were clearly a strong outfit. However, on the day Painswick were up to the task and emerged convincing winners by 26 points to 13.

For Painswick, new man Aussie Smith scored a try, as did his wing-threequarter colleague, Russell Sturmey. Alastair Bressington kicked four penalty goals and two conversions.

Last Saturday, Painswick were at home in the fourth round of the Tetley Bitter Vase Competition against old rivals Cheltenham Civil Service. The home advantage, plus the fact that Painswick play in Division One of the Gloucestershire League and the Service in Division Two, meant that the Cherry and Whites began as favourites.

The match proved to be hard fought, but a rugby team's success has to be based on the strength of its pack and the Painswick "eight", as so often this season,

dictated the game's direction, ably supported by full-back Bressington's solid defence. The visitors were successful with two penalty goals before half-time, but that proved to be the extent of their scoring in the match.

Painswick's scorers were Alastair Bressington (four penalty goals, two conversions, one try) and a well-deserved try by hooker "Ripper" Russell. The result means that Painswick find themselves in the last 32 of the national competition where they will meet a comparable status side from the South West of England.

After the game coach Wayne Lee said that the club was in a healthy position both on and off the field. The playing strength had increased to the point where there were sufficient numbers to put out a third fifteen and this was under consideration.

- Results [(L) indicates league match]
- Sat 3 Nov. Tetley Vase. Southmead 1st XV 8 Painswick 1st XV 38. Painswick United 33 Cainscross United 3.
  - Sat 10 Nov. (L) Old Bristolians 1st XV 25 Painswick 1st XV 34. Painswick United 13 Old Centralians 2nd XV 24.
  - Sat 17 Nov. (L) Painswick 1st XV 26 Aretians 1st XV 13.
  - Sat 24 Nov. Tetley Vase. Painswick 1st XV 26 Cheltenham Civil Service 6. Painswick United 5 Chosen Hill XV57.



**Allen Hale**  
Your local stockist for  
The Real Meat Company

**Allen Hale**  
New House, Friday Street  
Painswick. Tel 01452 813613

BRINGING YOU FLAVOUR  
WITHOUT EQUAL.  
WELFARE WITHOUT COMPROMISE

General Building Maintenance  
Patios, Garden walls  
Dry Stone Walling



**Richard Twinning**  
General Builder  
(14 years' experience)

Hard landscapes  
Small extensions etc

Tel: 01452 812086  
Mobile: 0789 9791659

## Painswick Seniors golf news

The Annual Dinner on 4th November and the AGM the next day signalled the end of Alan Fisher's reign as Seniors' Captain for the 2000/01 year. Alan reported a healthy membership of 64 seniors, of whom 45 had played in matches with other clubs. Of the 32 matches played, 13 were won, 14 lost, four drawn and one cancelled.

President Alan Cale will be eligible to join this coming year and David Walker as Club Captain is also an active senior golfer. David thanked the Seniors for actively supporting his charity of the year, the Cancer Unit in Cheltenham, that had benefited by £2000 to date, with several months to go.

Trophies and prizes for the major summer competitions were presented as follows: Senior Champion over two rounds - Duncan Twose (gross score) and Seniors Tankard (net score)- Ken Morris; Centenary Cup (best two out of three medal rounds) and Millenium Trophy (Stableford) both won by Bob Chitty; Ironman Trophy (singles knock-out) - John Glover; Arthur Paget Stableford

Trophy - Brian Webb; Organ Niblick (3 club and putter Stableford) - Malcolm Booth. A certificate was presented to John Weston for his successful organisation of the Painswick Senior Open for the last three years.

At the AGM, Alan Fisher handed over to John Webb, the newly elected Senior Captain. John nominated Nick Turner as his Vice-Captain. Secretary (Stan Sidman), Treasurer (Jim Eva) and Competition Secretary (Ian Smethurst) were all re-elected. Jim Hodge and Duncan Twose were elected Open organiser and Opens co-ordinator respectively. Winter four-ball and eclectic competitions. continue through the winter. New recruits are always welcome.

**Jim Hodge**

Trevor Smith of Kings Mill Lane completed the Stroud Half Marathon in 1 hour 58 minutes, raising £450 for The Haven Family Centre in Gloucester. He wishes to thank all those who sponsored him including in particular Hamptons, his Tennis Club friends and his neighbours.



# Go-ahead at last for Hollyhock Lane

The Parish Council has been awaiting the County Council's approval to effect the surfacing of Hollyhock Lane. Clerk to the Parish Council Peter Grant has told the Beacon that, after receiving the approval last week, the Parish Council has put the work out to tender.

On receipt of tenders, the Council will award a contract and progress the work as quickly as possible. The County Council has told the Parish Council that it cannot make its agreed contribution to the work in this financial year. However, it will reimburse the Parish Council after 1st April 2002.

## Christmas Bingo for Cobalt Unit

Rendcomb College Christmas Fayre last month raised £477.49 for the Cobalt Unit Fund Appeal. Suzie Archer, Ann Kemmett and myself baked Christmas cakes and mince pies for the event, and there were also chutneys and marmalades, and chestnuts picked up in Brittany.

Our last event for this year will be Christmas Bingo at Christ Church Rooms on 7th December, 7.15 for 7.30pm. Mince pies, tea and coffee will be served (no charge) at half time. Hoping you generous people will support us yet again.

Money raised by the Washwell Team: 1999 - Motor Neurone Disease, £1050.64; 2000 - Cobalt Appeal Unit, £2194.00; 2001 - Cobalt Appeal Unit, £2956.47. Total £6201.11. **Jane Gardiner**

## GODDARDS GARAGE

Cheltenham Road, Painswick



- \* Brake Safety Centre
- \* Full servicing & repair facilities
- \* Pre-MOT checks/MOTs arranged
- \* Ti Crypton engine tuning service
- \* Petrol/Diesel/Tyres/Exhausts
- \* Private Hire Taxi
- \* Paraffin/Coal/Calor Gas/Charcoal

Telephone - **812240**

## Brush up on china painting



China painting classes are proving quite an attraction on Tuesday afternoons in the Library Rooms. There are always places for a few more keen to try their hand at this challenging pastime. When the Beacon photographer called, eight keen

artists were tackling their painting a plate project with their tutor, Sally Andrews. They were: Karen Spencer, Enid Attenborough, Gill Mitchell, Pauline Turkie, Jean Morley, Gillian Bowl, Pam Sparrow and Pansy Jones.

## Beacon Quiz postponed to the autumn

A while ago, the Beacon announced that we expected the next Quiz Night would be on 16th March next year. The annual Quiz has run for several years now, and we felt it was time to examine whether any changes might be due - whether in its format, timing, style of questions etc.

What we have been told is that the Quiz, an event which draws together representative teams from 20 or more local organisations, is appreciated, but that some changes would be welcomed.

One change is to hold the event in the autumn, rather than in March as has been the case so far. There is a strong suggestion that doing this will enable more to participate since there will be slightly fewer competing events about that time.

So we have decided to postpone it until October or early November next year. Please watch out for the new date.

For Christmas services at Prinknash Abbey and the Catholic Church in Stroud, please see the notice board in the Catholic Church, Friday St., Painswick.

## More business car parking slots at Painswick Centre

The Painswick Centre has three car parking slots available for business users. The parking permits will allow parking in specifically allocated places from Monday to Friday, during normal working hours, plus Saturday use, if required. Contact the Centre, if interested.

Only four fewer than last year - so far!

Beacon subscribers - at 20th November		
	2001-02	2000-01
New (or returned)	79	91
Renewed	548	542
to date	627	633

### THE GARDEN PLAN

Landscaping Patios Fencing  
Trees Borders General Maintenance

An established professional service for over 7-years

Stuart Colley

01452 81 43 79

07932 97 26 75 (mobile)

PAINSWICK

stuart@upperwashwell.netscaponline.co.uk



## The Falcon Inn

Superb LUNCHES and DINNERS in our restaurant every day. Bar snacks, morning coffee.

The recently refurbished STABLES ROOMS are available both daytime and evenings, complete with their own bar, for your private receptions and parties of up to 60 persons.

Our en-suite bedrooms have every modern facility and are ideal if you have friends or relatives coming to visit you in the PAINSWICK area

Call FIONA or JON on 01452-814222 for more details



# Brian de Courcy-Ireland

Brian de Courcy-Ireland died in his sleep at first light on Remembrance Sunday, 11th November, aged 101. For the penultimate survivor of the Battle of Jutland and a naval veteran of both World Wars, this was remarkably appropriate timing.

An obituary in *The Times* summarised his career; sufficient here to note that he joined the Royal Navy at 12 and served continuously for 38 years, mainly in the Fleet Air Arm. He travelled the world, was torpedoed, had crash landed, faced death in action and survived, and commanded the famous HMS Ajax. He finally retired in 1951 as Deputy Director of Naval Equipment. His length of service and clarity of memory led to significant interviews by the Imperial War Museum and a place in Naval Archives.

On 1st December 1927, Brian married Ruth Jones, the daughter of a naval Captain, at Alverstoke and thus started almost 74 years of a very happy partnership. Service life can be hard on wives, and pay and conditions between the wars tested even the most devoted, but Ruth's naval background combined with Brian's upbringing by clergy parents and grandparents served them well.

In retirement, near Bath, he became PCC Treasurer, then Churchwarden, a member of the Diocesan Conference and the Diocesan Board of Finance, as well as of a Pastoral Revision Committee and a discussion committee with Roman Catholics. After intervening years in Amberley, his family persuaded them to buy Little Garth in Tibbiwell in 1980. This opened up a new lease of life with the Field



Club, Lent Groups, long walks, the Men's Coffee Hour, Painswick's Victorian Day ("I am a Victorian"), an immaculate garden and very sociable habits. When over 80, Brian read at St Mary's and he continued a firm Christian faith with prayer beside his bed every night. Aged 99, he talked without notes to the Senior Circle, extracting from a lifetime of jottings and diaries published by his family as a 450-page autobiography.

Self interest was anathema to Brian and good manners never failed him; modesty, generosity and courtesy was the way of life which expressed his family motto 'Amor et Pax'. He had a remarkable rapport with his many small great-grandchildren and his dry wit entertained family and friends alike. The remark 'While there is death there is hope,' originally said of a recalcitrant cleric, amused him enormously. Perhaps we can now say this of him as a valediction.

Douglas Robinson

## Coffee morning for Sue Ryder Care

The Annual Coffee Morning in aid of Sue Ryder Care will be held in the Town Hall on Saturday, 8th December, from 9.45am to 12 noon. Coffee, tea, hot chocolate and home-made mince pies at 75p. There will be a raffle, cake stall, general stall, Christmas cards and fresh flowers and plants. Do come and support this hospice appeal from which so many in Painswick have had the benefit. A warm welcome will be extended to all our regular and hopefully new supporters.

I would like to take this opportunity to pay tribute to Naomi McLaurin-Jones and Joyce Tranter who have stood down as co-ordinators after five years, since they took over from Elizabeth Hines. I hope with their and the team's backing we can continue the good work.

Anne Leoni

## Life on the farm by Cranham author

"Once upon a time there lived a farmer, Lewis Daw." So begins the fascinating story of the life of one of Cranham's most active residents, now published as volume one, "Daw and Daughter".

Beth McDonald grew up in a Gloucestershire farming family and from a very early age was actively involved in the country skills of farming, gardening, cooking, laundry, cheese-making and leisure activities.

Helped by diaries, volume one of her life story takes us from her birth in 1921, through her childhood and school days, the war years, marriage to Mac, and their journey out to Africa, where Mac was an estate manager in Kenya through troublesome times.

Ending with their return to England with their three young children in 1957, Beth writes with wonderful detail and humour.

There will be a launch of Beth's book on Sunday, 9th December at 5pm in Cranham Village Hall. She warmly invites all her friends to join her, with a glass of wine, to celebrate this occasion. Her book can be purchased from Beth herself (812194), or from me (814367), for £9.

Gill Cox

## Places on London coach

Seats are still available on the coach to London next Wednesday, 5th December. It leaves Stamages Lane Car Park at 8.30am. Fare £9.

Bookings, cash or cheque (payable to Painswick L & B Outings), should be made with Joan Truman, Little Place, Hollyhock Lane, Painswick GL6 6XH.

Enquiries to Joan Truman, 813965, or Pauline Berry, 813227.

## TREE SURGERY

- Mature Tree Maintenance
- Thinning & Reshaping
- Tree Removal & Chipping
- Hedge & Shrub Trimming
- Fruit Tree Pruning



Member of the Association of Professional Foresters

Landscapes House Churchdown

Glos. GL3 1NX 01452 535165

OVER 20 YEARS EXPERIENCE

Free Consultation - Fully Insured

GRAHAM FEAKINS HND

**A. J. FERN**  
CARPENTER-JOINER

and  
General Building Services

Telephone: Stroud 750105

**PAINSWICK ELECTRICAL SERVICES**

N.I.C.E.I.C. approved CONTRACTORS

SERVICE

INSTALLATIONS

REPAIRS



The Electrical Contractors Association

Mr M TURNER

01453 758342 and 01452 812659

Mobile: 07850 784899



# Genius of the Modern Tailor

## Painswick Local History Society

That was the headline used by the Piccadilly Magazine in 1925 for an article on Hill, Paul & Co of Stroud. Hill Paul had taken over the business and premises from Williamson Tratt in 1902 when the latter company failed. The premises consisted of the brand new factory designed by local architect Vincent Lawson, built of Stonehouse brick with Bath stone trimmings to the main entrance, and incorporating state-of-the-art fire precautions and sanitary arrangements.

Mr Michael Bird, great-grandson of William Henry Paul, co-founder of the company, recounted the story of Hill Paul & Co for Painswick Local History Society. The business was wholesale clothing for the off-the-peg market, a development that had been pioneered in Stroud by Holloways. Hill Paul's products included working clothes, military uniforms, riding breeches and suits. Their trademarks were 'Cotswold Clothing' and 'Cavs' (probably reflecting the large numbers of cavalry twill trousers produced). As well as a strong domestic market, Hill Paul exported to the continent. As the Piccadilly Magazine recognised, Hill Paul

was a major player in the wholesale clothing trade in the early part of the 20th century but after the Second World War business declined and the company closed in 1964. The factory worked on under other owners until 1989.

The Hill Paul building is currently something of a *cause celebre*, with dedicated Stroudites, led by the Civic Society, attempting to save it from demolition. As Michael Bird acknowledged, some people hate it, some love it and many are indifferent to it. He argued, however, that it is undoubtedly a landmark building and that if it goes Stroud will feel the loss. £1.3million is needed urgently to secure the building's future.

Mark Bowden

## Help trace lost book

Please, let nobody feel offended by this plea, but I do need help in tracing the whereabouts of a beloved book that I have lent somebody in the past year or so.

Stupidly, I failed to note the borrower's name in my usual list. The book is *Reminiscences of the Russian Ballet* by Alexandre Benois. It is hard-backed, bound in pine-green cloth, about one and a half inches thick, and has my name in it.

Eileen O'Sullivan, 812613

## Painswick Horticultural Society

### Lawns should never be the same after this

Members of Painswick Horticultural Society, with or without lawns, were intrigued by the talk on this subject by Mr J.A. Perkins on 14th November. He is an authority on most aspects of gardening, having spent a considerable time as Superintendent of Gardening at Bristol University.

His talk was comprehensive and beautifully planned, as he recommended the treatment we should mete out to our lawns in all seasons of the year, the problems of maintenance, and how to cope with the various creatures that are intent on thwarting us.

Mr Perkins's slides, forming the second part of his talk, demonstrated perfectly the points he had made, as well as in many cases being pleasing to the eye.

Altogether, this was a most informative and well-presented evening, leaving us well-equipped to produce the splendid greensward for which our country is renowned.

Pauline Lamont

## PROPERTY REPORT at 25th November from Hamptons Painswick agency

Christmas will soon be here and with it comes the expected lull in the property market. However, although there was a definite downturn in the market in September, October was our best month for exchanges in recent years. Naturally these sales were put together in the summer as it often takes up to three months from agreeing a sale to an exchange of contracts.

Activity has increased over the last few weeks where we had a contract race on one property, and then a bungalow in Castle Hale Drive proved so popular we had about eight interested parties and we achieved well in excess of the guide price.

Realistic pricing of properties in a good situation will always achieve the

asking price and sometimes more.

Have you seen our "Open House" boards around the village on Saturdays - where a property is open to the public for a short period of time. The vendors are not usually present, and group viewings seem to motivate genuine purchasers to make offers there and then. Last Saturday we had four open houses and about 40 viewings - a very busy and successful day for all concerned. Hamptons, as a company, opened about 100 houses on the same day over their network of offices.

Recent exchanges include: Dry Knapps Farm, Edge Lane; Mantle in Wood-borough Close and the separate building plot; The Laurels in Sheepscombe and Cromwell House,

Haresfield Beacon.

Among our recent instructions are: The Weavers House and adjoining Stone House in the centre of the village - both currently commercial, but planning permission to convert to residential has been applied for; Croome House in Bisley Street, a fine Grade II listed gem of a house; also Woodham Cottage in Tibbiwell, a charming three-bedroomed house in the centre, and Mulberry House, a detached four-bedroomed house in Churchill Way.

May we take this opportunity to wish you all a very merry Christmas and happy New Year; if we can be of help to anyone on property-related matters, please do give us a ring on 812354, or call into our office.

**MURRAY'S**  
INDEPENDENT ESTATE AGENTS

FOUR COTSWOLD OFFICES &  
MAYFAIR LONDON

Victoria Street Painswick

01452 814655

www.murraysestateagents.co.uk

**HAMPTONS**  
INTERNATIONAL

The Old Chapel, Bisley Street  
Painswick, Glos. GL6 6QQ  
Tel: 01452 812354

email [painswick@hamptons-int.com](mailto:painswick@hamptons-int.com)  
The ultimate property search: [www.hamptons.co.uk](http://www.hamptons.co.uk)



# Taking a closer look at our landscape

What do you see from your windows or when you walk around Painswick? What do you really see? It is easy to take the landscape for granted, but Painswick Local History Society has plans to persuade us to look anew.

Taking as our watchword the late Professor WG Hoskins's dictum that 'the landscape is the richest historical record we possess,' Painswick Local History Society is embarking on a long-term Historic Landscape Project.

This will be a map-based exercise, with volunteers using their observational skills and local knowledge to record earthworks and other historic features in the landscape. Historic maps and aerial photographs will be consulted, but the

## Painswick Local History Society

landscape itself is regarded as the primary source of evidence. Any features that appear to be of particular interest might then become the subject of more detailed, large-scale survey. The Project will use only non-intrusive, non-destructive techniques; and no excavation is planned.

The outcomes of the Project could be many and varied, but they will certainly include a new historic map of the civil parish of Painswick, and the input of information to the County Sites and Monuments Record, where it will inform the planning process. This Project might

also form the first stage of a larger programme including, for instance, architectural and documentary research.

Our Project can be seen as extending the landscape element of the Stroudend Tithing Educational Trust's work (see articles in earlier issues of *The Beacon*) to the other tithings of the parish.

Volunteers do not need specialist knowledge – guidance and information will be at hand. All that is required is observation – a fresh, more open way of looking at a familiar environment. This is intended to be a project for the people of Painswick, by the people of Painswick. If you would like more information or would like to get involved, contact Mark Bowden at 2 Beech Tree Terrace, Edge.

## Queen's wedding message at WI

Taking pride of place on the President's table as members entered the hall stood a large greetings card, bound with gold cord.

The photograph on the front showed the Queen, smiling happily, wearing a red dress, pearl necklace and diamond brooch.

Inside, the card carried HM's signature below a message congratulating Mr and Mrs Frederick Semark on the occasion of their diamond wedding anniversary on 15th November 2001 (curiously enough, the exact date of our meeting).

Flora told us: "When Fred and I married in Stroud in 1941 we had no idea that we should be spending our retirement in the same area."

Displayed on tables along four sides of the hall was an impressive array of our members' craftwork, arranged by Audrey Watts. This included calligraphy, quilting, patchwork, cross stitch (the finest imaginable), knitting, hand-made teddies, photos of members taking part in their activities over past years, precious china that had been skilfully repaired.

During the Annual Meeting that followed, Barbara Thorley was sincerely thanked for her efforts in serving for three years as secretary, followed by four years as president of our institute.

Members unanimously elected Dorothy Daniels and Shirley Purdey as joint presidents as from January, a new departure for us to spread the load.

Meanwhile members promised to supply ample sandwiches and cakes, plus half a dozen teapots and some raffle prizes for the Christmas meeting. Roll on, 13th December!

Dorothy Binns

### Thank you, says Dr Jim

Dr Jim Hoyland and family wish to thank everybody for their cards and good wishes for his recovery after his recent operation.



## In praise of birds

There was a good attendance on 6th November to hear Robin Coates of Cheltenham Bird Club talk about birds of prey, accompanied by some excellent colour slides. The main subjects were Snowy Owls and Gyr Falcons, although the remaining birds of prey in the Arctic were also covered comprehensively.

It is amazing that these birds are able to survive in such numbers and conditions, but this is down to their ingenuity in finding sufficient food to survive and multiply.

Our speaker, who is in his eighties, had obviously maintained his enthusiasm and interest, and covered much territory around the world in his research.

Harold Wood

## Roland Boggom

Chartered Accountant

Fast & Efficient Service  
Limited Companies  
Partnerships & Sole Traders  
For all your Accounting, Tax  
and Business Advice  
Telephone 01452 812075

## PAINSWICK VILLAGE DENTAL SURGERY

Les Robinson B.D.S.  
Private, Denplan

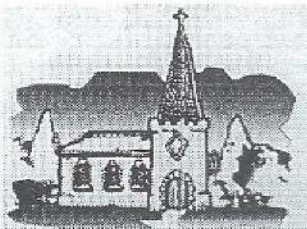

Appointments available 6 days  
a week and late evening Thursday

\* Cosmetic Dentistry \* Hygienist  
\* Personal Professional Service in  
Relaxed Atmosphere

TEL: 01452 814427

Hoyland House, Gyde Road, Painswick, Glos.  
GL6 6RD

## M. BAKER & SONS

Members Federation of Master Decorators

## PAINTERS AND DECORATORS

established in 1970

A family business specialising  
in quality decorating

Wentworth, Cowle Road, Stroud,  
Glos

01453 765502

24-hour mobile 07860 704044



# If 'Squire' was good enough for my father, it's good enough for me

*He who checks a child with terror  
Stops its play and stills its song,  
Not alone commits an error  
But a great and moral wrong.*

A portrait of 'Squire' Maude Cheap (nee Hemming) as MFH showed a remarkable person. Her love of the countryside, its sports, her acts of kindness and open-handedness to all have lingered long in the memory of those who worked around Bentley Pouncefoot manor in Worcestershire.

Tom Goulbourne's father worked one of the 145 farms on the 6,000 acre estate and Tom himself walked every day to the school that she built and funded for the estate children nearly 100 years earlier. So it was a labour of love for Tom to tell Maude's story to the Senior Circle. He was aided in this when he found a privately published memoir among his mother's possessions, written by

## Painswick Senior Circle by Patrick Daly

one of the surviving daughters. Maude was born in 1853. Following hounds at age four, she grew up becoming an accomplished musician, artist and poet, and running her own pack of harriers, being more interested in how they worked rather than the kill.

She 'came out' and soon after married Col. Cheap who had extensive estates in Scotland and hunted his pack of foxhounds, the first woman in the country to become MFH. She bore six children in ten years. Her brother and heir to the estate was a ne'er-do-well who had to agree to the old squire's radical proposal that Maude should inherit and run the estates (another in Worcestershire and three more in Scotland). So 'Missy,'

as she was affectionately known, became 'Squire' upon her father's death. She set about improving the livestock, modernising cottages, instituted a pension scheme, and sent workers on convalescence to the Isle of Mull estate.

But such good and such happiness seems to exact a price. A succession of personal tragedies followed, from which Maude could not recover.

Her youngest daughter was drowned crossing a loch on Mull. Her husband was killed in a riding accident. Another daughter, newly married, died when the Empress of India sank in Hudson Bay in 1914. One son fell in the 1914-18 war, and son and heir, Hugh, drowned bringing his regiment home from Egypt in 1919. Exactly one year after Hugh's death, Maude died.

After the Second World War, Tom and his wife, Sheila, returned to the place of his childhood. An iron-railed drive was overhung with rhododendrons, from which they emerged into an open space of brambles and weeds, odd piles of stones and tiles. Only this remained of a manor of 35 rooms and 25 stables. During the war it had been used for POWs. By 1945, it was beyond repair and knocked down. So ended a life in advance of its time.

*Give it play and never fear it  
Active life is no defect  
Never, never break its spirit  
Curb it only to direct  
Would you stop the flowing river  
Thinking it would cease to flow?  
Onward it must flow forever  
Better teach it where to go*

*Maude Hemming*

## Of aircraft and animals...

The early November talk to Senior Circle was dedicated to Aviation, a matter almost too technical for our audience, but nevertheless a subject we are in touch with one way or another almost daily, either as a traveller or reading the newspaper.

Ralph Tyler certainly spent much effort, with books, data and illustrations, explaining the complicated systems by which today's planes - and those of yesterday - keep flying. From childhood to manhood, planes have always held a fascination for him, and his career at Dowty's was the result. Barnes Wallis, Frank Whittle, Rolls Royce were all names known to us, but I am afraid others who played a vital part in the world of aviation we did not know. The Harrier, the vertical take-off aircraft, Concorde, Hurricane, Spitfire and even the R101 that some members remember, we could relate to. For those who do not exactly understand what goes on under a car bonnet, it certainly made an interesting afternoon.

On 17th November we heard about "Veterinary Nursing and after," a talk by Pip Millard who is a practice manager as well as lecturer on veterinary subjects in Gloucestershire. She gave us a most interesting and lighthearted talk and clearly loves her job - all at the same time as being married to a farmer and bringing up her small son.

Training to be a veterinary nurse covers many subjects from obstetrics and physiology to medicines and x-rays, and many more. There are exams as well as college training before one is fully trained.

We learned of a normal day at the practice: routine examinations and operations, counselling, Puppy Playgroups and even weight watching!

Lecturing at Hartpury College is another occupation she enjoys. Pip Millard also touched on her travels and experiences working on farms in New Zealand.

*Daphne Hudson*

### FREDWOOD FORESTRY

Contracting, Tree Surgery  
Firewood

Tel 01453 753601 Fax 01453 750530  
Mobile 07740 307983

### Building Repairs Painting & Decorating Carpentry

T MIFFLIN

Enquiries Welcome  
Telephone Painswick 813866

### ELECTRICAL AND ALARM SERVICES

New Installations, Rewires, Extra Sockets,  
Lights, Showers, Security Lighting,  
Economy 7 Heating, etc.

Professional intruder alarm  
systems fitted from £330.  
Remote control car alarms  
fitted from £70.

Door Entry and Closed  
Circuit Television Systems fitted

For a friendly, prompt and  
reliable service contact  
**Steve Gallagher**  
on 01453 791209

ALL WORK FULLY GUARANTEED  
WITH NO ADDED VAT



# The Players in a tense quandary

Readers, I am at a loss for words. You see, as I write this article, I realise that it will not appear until Saturday, 1st December, which – by strange coincidence – is/was/will be the last night of our current production, The Farnsdale Avenue Housing Estate Townswomen's Guild Dramatic Society's production of A Christmas Carol.

Consequently, it is/was/will be - tenses get very confused in these situations - all a bit late to give The Farnsdale etc a plug and yet still a tad early for the review. (Our reviews, despite what the cynics among you might think, are actually written after the production. No, they are, really. It's just that they're always so predictably good!)

Anyway, on the basis that a picture is worth a thousand words, I thought that, instead of my rambling on about how wonderful The Farnsdale etc undoubtedly was/is/will be, you would all far rather see this strangely inexplicable photo from one of the rehearsals.

On her knees on the left is Maggie Drake, next to her is Gill Cox, Lesley



## Painswick Players

Wolowiec and Lynne Gibson. The token male is Kevin Parker, co-director of the whole strange affair.

If all this whets your appetite for more dramatic derring-do, here's a quick glimpse of our plans for 2002. We are planning a 'rehearsed play reading' of The Wedding of the Year by Norman Robbins on a yet-to-be-agreed-upon Saturday afternoon in February in the Painswick Centre, supplemented by a scrumptious cream tea.

You may remember a not dissimilar event a couple of years ago that was a

tremendous success. Expect more of the same. Exact details will be in next month's Beacon. Salivate gently in the meantime.

Looking further ahead and just to prove how organised we have become, on Thursday 9th, Friday 10th and Saturday 11th May we will be staging the very funny Richard Harris comedy, Stepping Out. Stepping Out follows the progress of a tap dancing class of hopeful hoofers, from their first tentative trips to their final triumphant performance, and explores the complex relationships that develop between the different characters and their very different backgrounds.

One key requirement is that everyone in the cast needs to be able to tap dance. Such is the enthusiasm to take part that there is a dedicated Painswick Players tap dance class each Saturday morning!

Jack Burgess

[www.geocities.com/painswickdramaticsociety](http://www.geocities.com/painswickdramaticsociety)

# Beethoven and Verdi delights

Painswick Music Appreciation Group had a welcome return visit on 25th October from Richard Farbrother, well-known Stroud piano tutor and Chopin specialist. He continued where he had left off last season, regaling us with some ten preludes and eight

## Painswick Music Appreciation Group

waltzes, mostly recorded by Ashkenazy, but some played by himself.

Ludwig van Beethoven wrote one opera, revising it twice. In its final form in 1814, it was called Fidelio. The original version is given Beethoven's preferred title, Leonore. We went to Bristol to hear the Welsh National Opera perform this on 8th November. About the plot and, for once, even the singing we formed mixed opinions, but were all agreed that, as was expected, the music was gorgeous.

The presentation on Verdi by Richard Burgess Watson on 22nd November was a resounding success; never has there been such applause from a large audience. More of that in the next issue. We now look forward to our Christmas special on 6th December, with wine, buffet and musical crossword. All are welcome, but for catering reasons it would help if you let Anne Leoni (812521) know that you intend to come.

Ralph Kenber

## CENTRELINE



SPECIALIST STONEMASONS  
& STONE CARVERS

CONSERVATION SPECIALISTS  
QUALITY CRAFTSMANSHIP  
EXPERT ADVICE

OFFICE: 01452 813892  
WORKSHOP: 01285 821074

FAIRFAX HOUSE • VICARAGE STREET  
PAINSWICK • GLOS • GL6 6XS

## OAKLEY GARDEN SERVICES LIMITED



For all your garden needs

MOBILE: 07979 590818  
TEL: 01452 814533

## PAINSWICK POST OFFICE

VERY HAPPY CHRISTMAS  
TO ALL CUSTOMERS  
FROM EVERYONE AT THE  
POST OFFICE



\* PRESENTS PRESENTS PRESENTS  
Huge choice of toys, including traditional wooden toys, dolls' houses, stationery, notelets, candles, candle sticks, picture frames, original watercolour paintings, aprons, tea cosies, pens, stocking fillers... and much much more

\*DON'T FORGET TO CASH your winter fuel payment with us

PAINSWICK POST OFFICE 812303



# The Painswick Beacon

VILLAGE DIARY to SATURDAY 19th JANUARY 2002

## December

Sat 1st	Coffee Morning: Bring & Buy Stall; Raffle - in aid of St John Eye Hospital in Jerusalem	8 Churchill Way	10am - 12 noon
	New Exhibition: The Spirit of Christmas	Tues - Sat Sundays	Fiery Beacon Gallery 11am - 5pm 2 - 5pm
	Painswick Bird Club: Visit to Slimbridge to see the Starling roost	Broad Walk Hide,	4.20pm
	Painswick Players - The Farndale Avenue Housing Estate Townswomen's Guild Dramatic Society's production of 'A Christmas Carol'	Painswick Centre	7.30pm
3rd	Austerity Lunch: Hosts - Puffins	Christ Church Hall	12.15 - 1.15pm
4th	Painswick Dog Training Club (Tuesdays) - Puppies and Beginners Intermediate Advanced Dogs	Christ Church Hall	9.30 - 10.15am 10.15 - 11am 11 - 12 noon
5th	Coach to London: Enquiries 813965/813227	Stamages Car Park	8.30am
	Painswick Probus:	Ostlers Room, Falcon	10am
	Old Time Tea Dance (Also 12th & 19th December.)	Painswick Centre	2 - 4pm
	Wives' Fellowship Social	Christ Church Hall	7pm
6th	Senior Circle coach to Cribbs Causeway - All welcome	Stamages Car Park	10am
	Cotswold Care Support Group Meeting	Ashwell House	2.30pm
	Cotswold Care Dinner	Painswick Golf Club	7 for 7.30pm
	Music Appreciation Group: Christmas Special	Town Hall	7.30pm
	Christmas Concert: A Box of Delights - A miscellany of Songs, Arias & Seasonal Tit-bits for Soprano, Tenor & Piano. £10 - includes Wine and light refreshments. Tickets - Shetland Shop	Pitchcombe Church	8pm
7th	W.I. Market (Fridays)	Town Hall	10am
	Eyes Down for Christmas Bingo - in aid of Cobalt Unit Appeal Fund	Christ Church Hall	7.15 for 7.30pm
	Painswick Conservatives Italian Evening. Contact 813815	Painswick Centre	7.30pm
	The Guild Gallery open for a special pre-Christmas event with mulled wine & mince pies. All welcome	Guild Gallery, Painswick Centre	from 7.30pm
Sat 8th	Sue Ryder Care Coffee Morning	Town Hall	9.45am - 12 noon
	A Celebration of 125 Years of the Mothers' Union: Advent Market	Tewkesbury Abbey Service	10.30am 2pm
	Christmas Concert - Painswick Singers	Christ Church	7.30pm
10th	Austerity Lunch: Hostess - Mrs June Tuffnell	Christ Church Hall	12.15 - 1.15pm





11th	Mothers' Union: 'The celebration of Christmas in the Orthodox Church' - Mrs Barbara Coker	Hazelbury Cottage, Edge Road	2.30pm
12th	Painswick Valley Carol Service	Christ Church	7pm
	Parish Council Meeting	Town Hall	7.30pm
	Painswick Horticultural Society - Members' Quiz Night	Town Hall	7.30pm
13th	W.I. Christmas Party	Town Hall	2.30pm
15th	Cancer Research Campaign - Christmas Fayre & Coffee Morning	Painswick Institute	10am - 1pm
16th	Senior Circle: Christmas Party	Town Hall	2.30pm
18th	Jazz Evening: Local Musicians, no entry charge	Ostlers Room, Falcon	8.30pm
19th	Painswick Probus	Ostlers Room, Falcon	10am
	Wives' Fellowship: Carol Service	Ashwell House	8pm
26th	Parish Council's Boxing Day Walk. All welcome	Stamages Lane car park	10am
30th	<b>COPY DATE: All items to Jillie Speed, The Old Carriage House, Edge, or Beacon Mailbox in New Street</b>		

#### January 2002

3rd	<b>DIARY DEADLINE: All items to Mrs Edwina Buttrey, 14 The Croft, or Beacon Mailbox in New Street</b>		
	NO Cotswold Care Support Group Meeting	Ashwell House	
Sat 12th	<b>January Issue of The Painswick Beacon Published</b>		
Sat 19th	Introduction to Western Line Dance (in aid of Dyslexia Association)	Painswick Centre	8 - 11pm

#### NOTES

Please use the space below to jot down events and dates to put into your personal 2002 diary





# A bit of mud-raking in Painswick's past

Mud-raking is not new in Painswick. All is revealed in the Painswick Chronicle, Issue number 5, which will be available early this month. This Local History Society annual publication is making a slightly later appearance this year due to technical hiccoughs, but the final result will, we hope, be as welcome and well received as previous issues.

The Chronicle has been highly praised right from the first issue five years ago. A great deal of hard work and effort, all on a voluntary basis, is invested in its production to ensure the end product holds something of interest for everyone. This year's issue is no exception. The articles are very wide-ranging.

Education in Painswick from its beginnings to the present, two remarkable 19th century ladies from Ebworth, a family of Painswick clothiers, a well-known composer with Painswick connections are all included. You are invited to consider a hypothesis about a local boundary wall and to ponder reminiscences written 50 years ago.

Then there are reminiscences recorded and transcribed this year as part of the Society's Oral History Project. So many Painswickians have fascinating memories of ordinary life here in years gone by, and here is an opportunity to share those memories, either by tape recording their own for posterity or by reading them in the Chronicle.

This is a valuable method of keeping social history alive and on record, and the Society is happy to collaborate with anyone who would like his or her personal memories recorded.

Of course, these are just some of the articles. Overall, they range from the

personal to the erudite, the light-hearted to the chin-stroking weighty. Whatever your preference, a little knowledge of Painswick past, its people, its way of life, its buildings and so on does undoubtedly make you look around with a fresh eye.

*Barks and Bites From Bow-wow Land* is also available, a slim little volume guaranteed to raise a few smiles with its claims to longevity for Painswick folk (perhaps not so far from the truth). And Carl Moreland's beautifully presented *Painswick: Time Chart of a Cotswold Village*, tracking Painswick's development alongside national historic events, is on sale too.

All these publications, plus Issues 3 and 4 of the Chronicle (1 and 2 are now sold out), are on sale in local retail outlets or are available direct from the Society (Call me on 813387). They all represent very good value for money, make splendid Christmas presents and generally provide a jolly good read.

Carol Maxwell

## Spirit of Christmas exhibition

The new exhibition, just opened at the Fiery Beacon Gallery, presents an affordable array of possible presents for those who are most important in your life. Santa Clause can certainly bring me one of Eleyne Williams's exotic necklaces in wonderful semi-precious materials.

Painters, printmakers and collage makers are well represented; add ceramics, both decorative and practical, and jewellery in all its forms, glamorous scarves, headbands and neckpieces, even solid steel chairs, and a grand mix results.

Silver for your sweetheart, brooches for your beloved and glasses for your Granny (drinking variety, of course) and guardian angels for everyone, all say 'welcome' to the Christmas season.

The exhibition runs until Saturday, 15th December. Open: Tues-Sat 11am-5pm, Sunday 2-5pm.

Pam Bentley

### PRIVATE HIRE TAXI

**ALLAN & MARTIN WEAGER**  
(Formerly Rylands)

01453-763947 (Allan)  
01453-764845 (Martin)  
Allan (mobile): 07712-776470  
Martin (mobile): 07808 722255

## MINI-ADS

**Companion** needed to sit with an elderly gentleman in Pitchcombe (A46) for a few, flexible, hours a week to relieve wife to enable shopping, etc. 812526

**Canaries** - one bedroom bungalow on quiet beach-front resort with three pools. Restaurants and shops nearby. From £200p.w. Vacancies October onwards. 611873.

**Garden Storage.** Chest style top-opening metal galvanised unit, 190cm wide, 100cm high and 90cm deep approximately. Buyer collect from centre of Painswick. £10. 812825.

MINI-ADS - non-commercial, maximum of 30 words - are 10p per word with a minimum payment of £1. Maximum of 14 per month. *Beacon* subscribers have 25% discount.

Please send money with mini-ad to Leslie Brotherton, Longhope, Blakewell Mead, Painswick GL6 6UR. If paying by cheque, please make it payable to *The Painswick Beacon*. Receipts are not forwarded unless requested.

### THE PATCHWORK MOUSE

CLOSING AT CHRISTMAS

Half Price Sale - Everything Must Go

DO CALL IN AND  
BROWSE - YOU WILL  
BE MOST WELCOME



DAWN MALLINSON  
813122

### PAINSWICK OSTEOPATHS

Paul Stamp DO  
Helen Froggatt DO

BUPA



PPP Registered Osteopath

Painswick Doctors' Practice

**01452 301748**

Parking and evening appointments available

**No Drying Time\***

## Home 'n' Dry

We use only natural safe products.

Eliminates up to 85% of allergens.

Benefits Asthma sufferers.

\*Carpets are dry and ready for immediate use

- Carpets
- Upholstery
- Oriental Rugs
- Sisal
- Sea grass
- Odour Treatments
- Stain Treatments

# 01452 612229

Office: 22 Rowan Gardens Gloucester GL3 4DU



# The Personal Column

## Baby

Congratulations to HELEN and PAUL STAMP on the birth of their son, Andre Frank, on 16th November (a brother for Cornelia and Demelza).

## Engagements

Congratulations to: CHRISTOPHER RICH of Paradise and ELIZABETH WILLIAMSON of Boxgrove, West Sussex, and AMY PITT of Painswick and DAVID HILL of Stroud, whose engagements were announced recently.

## Emerald Wedding

Congratulations to JUNE and JOHN STANGROOM who have been married 55 years on 4th November.

## Diamond Wedding

And congratulations to FLORA and FRED SEMARK who celebrated their 60th wedding anniversary on 15th November.

## Comings and Goings

We would like to welcome JANET and JUDITH PARKINSON who are taking over at Chancellors Tea Rooms;

KATE and ED BUTCHER who have moved into Dialtryst, Vicarage Street;

KIM, FRANCES, LOUISE and PHILLIPA RODEN who have come to live at Beacon House, New Street, from Hong Kong;

Mr and Mrs BENTLEY and their triplets, who have moved into Culvert Cottage;

Mr and Mrs CASH and their children, Tom, Ben, Sophie and Hannah, who have bought The Laurels, Sheepscombe;

Mr and Mrs BOLD who are moving into Mantle, Woodborough Close;

Mr and Mrs SIDWELL who have moved to Lavender Down, Cheltenham Road;

and JOHN MUNDAY, CATHY and JOSEPHINE who have been living at May Cottage, Edge Road, since April.

Farewell to: The Haslams who have moved from Culvert Cottage to Chalford;

LOUISE, DAMIAN and LUKE MILLAR who are leaving Chancellors for Sheffield;

and HELEN DUNLOP who has gone back to Toronto after her ninth visit to Painswick.

## Change of House

DOREEN BIRT has moved to No. 26 Ashwell House; and GERALDINE and CHRISTOPHER PIPER-SHORT have moved to No. 9 Churchill Way from Vicarage Street.

## 80th Birthday

Congratulations from all the family to BERYL GYDE who was 80 on 13th November.

## Condolences

Our sincere sympathies to the family and friends of TED GYDE, Captain BRIAN de COURCY-IRELAND, and to ERROL TRZEBINSKI whose son, TONIO, was murdered in Nairobi recently (Errol lived in Vicarage Street for several years).

## Get Well Soon

Best wishes for a speedy recovery to JACK LEARMONT, JUDITH O'RIORDAN, PAT PARKER and JIM HOYLAND.

## Thank You

DOREEN and GRACE GYDE would like to thank all family, friends and good neighbours for cards, letters, flowers and visits after the sudden death of TED on 5th November.

ANDREW, ELAINE and CATHERINE LEACH would like to thank everyone for their kindness and expressions of sympathy on the death of PHYLLIS LEACH. Special thanks to everyone who visited her in hospital, to the wonderful staff at Cashes Green Ward in Stroud, and to the Rev. Peter Minall for the very moving funeral service.

After nearly three years as hosts at Chancellors Tea Rooms, LOUISE and DAMIAN MILLAR would like to thank everybody for their custom and friendship, especially on behalf of Luke, as they move away. Painswick and its people will always hold a special place in our memories, they say. They wish everyone well and will keep in touch.

## NEXT ISSUE

Publication Date  
SATURDAY, 12th JANUARY, 2002

Items for publication to Jillie Speed, The Old Carriage House, Edge, by  
SUNDAY, 30th DECEMBER

Mini Ads to Leslie Brotherton, Longhope, Blakewell Mead, by  
SUNDAY, 30th DECEMBER

Business advert amendments to Liz Fisher, Harebell Cottage, Blakewell Mead, by  
THURSDAY, 27th DECEMBER

Diary items (only) to Edwina Buttrey, 14 The Croft, by  
THURSDAY, 3rd JANUARY, 2002

Letters and articles for publication are welcomed on computer diskette (returned after use) or by email to: [painswickbeacon@supanet.com](mailto:painswickbeacon@supanet.com) Items to be published, and other mail for the Beacon Committee, can also be placed in the Beacon Post Box in New Street (next to the telephone kiosk). Please provide your name, address and a contact phone number.

## Editorial Team:

Editor: Tony Crook	814500
Asst Editor & Sport: Terry Parker	812191
Editorial Asst: Jillie Speed	814148
Personal Column: Rachel Taylor	813402
Diary: Edwina Buttrey	812565
Clubs & Socs: Carol Maxwell	813387
Gen Features: Iris McCormick	812879
-----	
Business Advertising: Liz Fisher	812130
Distribution: Arthur Lock	813565
Treasurer: Leslie Brotherton	813101

## DAVID ARCHARD

In association with  
Philip Ford & Son Ltd

**FUNERAL DIRECTORS**  
AN INDEPENDENT FAMILY BUSINESS

*Private Chapels of Rest*  
*24 Hour Personal Service*

DIRLETON HOUSE  
CAINSCROSS ROAD  
STROUD

01452 812103  
or 01453 763592

The  
**Anthony  
Fisher**  
Curtain Company

## SPECIALIST CURTAIN MAKER

*A very personal advice and making service for simple drapes or elaborate window dressings. For an appointment to see thousands of fabrics, everything from Sandersons to Coloroll, in your home or my office/showroom at:  
41 Brunswick Road, Gloucester  
Please ring Glos 309333 (day) or Painswick 812130 (evenings).*